

# Plumb-Spec™



*Specification Grade Products for the Plumbing Professional*



## ***Stainless Steel Products***

# Plumb-Spec™

*Specification Grade Products for the Plumbing Professional*

## Lifetime Warranty\*

Stainless steel tubular has a lifetime corrosion resistance of citric acid, fruit juice, milk, nitric acid, sodium chloride, and vinegar, while brass tubular shows severe corrosion effects from all of these materials. It's also considerably safer for the environment!

7529 Perryman Court  
Unit 1  
Curtis Bay, MD 21226

11156 Wright Road  
P.O. Box 1747  
Lynwood, CA 90262

Phone: 877-377-6465  
Fax: 877-377-6466  
E-mail: [johnb@pascospecialty.com](mailto:johnb@pascospecialty.com)



*\* Please call for details.*

*This is truly the solution to the problem that you have been looking for!*



# Plumb-Spec™

*Specification Grade Products for the Plumbing Professional*

## **PASCO, a leader in the plumbing specialty industry, proudly introduces its all new line of stainless steel tubular products.**

Unlike chrome plated brass, plastic, or copper DWV; PASCO's Plumb-Spec™ line of stainless steel tubular has the absolutely best resistance to the effects of:

- Citric Acid • Nitric Acid • Sodium Chloride • Acidic Drain Cleaners • Vinegar
- Hand Sanitizers • Also, food wastes including tomato, fish, coffee, tea
- and much more!

PASCO'S Plumb-Spec™ stainless steel tubular is a new green product line, due to the fact that environmentally unfriendly chrome plating is not used or required.

Listed on the following pages are other Plumb-Spec™ stainless steel plumbing specialty items. PASCO Plumb-Spec™ products are specifically engineered from the highest grade of stainless steel for installations in:

- Restaurants • Hotels • Hospitals • Schools • Laboratories
- Food Preparation Facilities • Sports and Athletic Facilities • Military Facilities
- Seaport and Marine Facilities • Parks and Recreation Facilities
- Anywhere long term service is required!



**TUBULAR PRODUCTS**



**EZ ON BASKET  
STRAINERS**

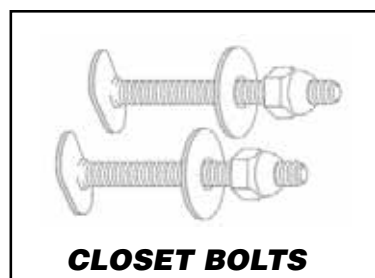

**CLOSET BOLTS**

**Corrosion Proof - Strong - Economical!**  
**Corrosion Proof - Strong - Economical!**  
**Corrosion Proof - Strong - Economical!**



# Plumb-Spec™

Specification Grade Products for the Plumbing Professional

## STAINLESS STEEL P-TRAP - LESS CLEANOUT - 8" WALLBEND

Chrome plated brass nuts

Stainless steel regular and box flange - slip joint washers - beaded



### SS FLANGE ONLY

PART NUMBER	SIZE	STYLE
37244	1-1/4"	REGULAR
37224	1-1/2"	
37236	1-1/4"	BOX
37237	1-1/2"	

### COMPLETE P-TRAP

PART NUMBER	SIZE
37106	1-1/4"
37110	1-1/2"

### WALLBEND ONLY

PART NUMBER	SIZE
37128	1-1/4" x 8"
37136	1-1/2" x 8"
37132	1-1/4" x 15"
37138	1-1/2" x 15"

Add a "P" for polished.



## SS LOS ANGELES CODE SINK TRAP



### COMPLETE TRAP

PART NUMBER	SIZE
37140	1-1/2"

PART NUMBER	SIZE
34141	1-1/2" CP outlet elbow ONLY

Add a "P" for polished.



## SS GROUND JOINT P-TRAP

### COMPLETE P-TRAP

PART NUMBER	SIZE
37109	1-1/2" x 1-1/4"
37111	1-1/2"



PART NUMBER	DESCRIPTION
37190	1-1/2" J-BEND ONLY
37130	1-1/2" x 9" WALL BEND
37132	1-1/2" x 15" WALL BEND

Add a "P" for polished.

# Plumb-Spec™

Specification Grade Products for the Plumbing Professional

## SS DOUBLE OFFSET 12"



PART NUMBER	SIZE
37530	1-1/4" x 12"
37532	1-1/2" x 12"

Add a "P" for polished.

## GRID STYLE LAVATORY DRAINS WITH STAINLESS STEEL TAILPIECE

Chrome plated cast brass strainer Brass locknut

Wheel chair accessible



1-1/4" x 6"

PART NUMBER	DESCRIPTION
1177-TP	With Tailpiece
1177	Elbow ONLY
1176	Grid Drain

Add a "P" for polished.



1-1/4" x 9"

## SS SLIP JOINT EXTENSION TUBE

Chrome plated brass nut



PART NUMBER	SIZE
37406	1-1/4" x 8"
37408	1-1/4" x 12"
37416	1-1/2" x 8"
37418	1-1/2" x 12"

Add a "P" for polished.



## SS EXTENSION TUBE

Threaded both ends



PART NUMBER	SIZE
37452	1-1/4" x 12"
37464	1-1/2" x 12"

Add a "P" for polished.



## SS SINK TAILPIECES

Flanged one end or both ends



### SS SINGLE FLANGED END

PART NUMBER	SIZE
37347	1-1/4" x 8"
37352	1-1/2" x 8"



### SS DOUBLE FLANGED END

PART NUMBER	SIZE
37364	1-1/2" x 12"
37366	1-1/2" x 16"

Add a "P" for polished.



STAINLESS STEEL PLUMBING SPECIALTIES  
PAGE 5

## PACKAGED ALL STAINLESS STEEL CLOSET BOLT SETS

All stainless steel bolts, nuts and washers  
Marine grade 305 stainless steel - packaged one pair per bag  
Easily cut with Tiny Tim Hacksaw

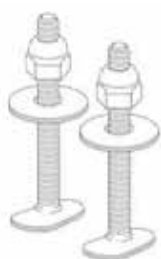

2 Stainless Steel  
Bolts, Nuts & Washers

PART NUMBER	SIZE
100-SS	1/4" x 2-1/4"
94-SS	1/4" x 3-1/2"



2 Stainless Steel  
Bolts, Nuts & Washers  
2 Tinnerman Nuts

PART NUMBER	SIZE
102-SS	1/4" x 2-1/4"
107-SS	1/4" x 3-1/2"

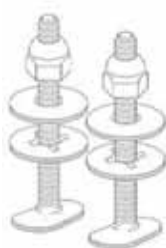

2 Stainless Steel  
Bolts, Nuts & Washers  
2 Plastic Speed Washers

PART NUMBER	SIZE
102-SSN	1/4" x 2-1/4"
107-SSN	1/4" x 3-1/2"



2 Stainless Steel  
Bolts, Nuts & Washers  
2 Tinnerman Nuts  
2 Plastic Bolts Caps

PART NUMBER	SIZE
106-SS	1/4" x 2-1/4"



"DOUBLE NUT"  
2 Stainless Steel Bolts  
4 Stainless Steel Nuts  
& Washers

PART NUMBER	SIZE
28-SS	1/4" x 2-1/4"
30-SS	1/4" x 3-1/2"

Bulk Stainless Steel  
Bolts, Nuts & Washers - 100 Pack

### Bolts Only

PART NUMBER	SIZE
104-SS	1/4" x 2-1/4"
111-SS	1/4" x 3-1/2"

### Nuts Only

PART NUMBER	SIZE
1647-SS	1/4"

### Washers Only

PART NUMBER
140

# Plumb-Spec™

Specification Grade Products for the Plumbing Professional

## STAINLESS STEEL TANK TO BOWL BOLT SETS



EACH SET CONTAINS:  
2 Stainless Steel Bolts  
4 Stainless Steel Hex Nuts  
4 Cloth Inserted Rubber Washers

PART NUMBER	SIZE
237-SS	5/16" x 3"

## TANK TO BOWL CONNECTOR KIT With Rubber Gasket



EACH SET CONTAINS:  
1 Rubber gasket  
2 Bolts- Stainless Steel  
4 Heavy washers- Stainless Steel  
4 Rubber Washers  
4 Hex nuts- Stainless Steel

PART NUMBER	GASKET TYPE
437-SS	Regular
439-SS	American Standard

## CLEANOUT COVER PLATES



Polished stainless steel  
Countersunk hole will accept both 1/4" and 5/16" bolts  
22 Gauge metal  
With screw for plastic add -S to part number  
Made in U.S.A.

Cover plate with  
1/4" x 20 x 4" bolts

PART NUMBER	SIZE
1840	3"
1841	4"
1842	5"
1843	6"
1844	7"
1845	8"

Cover plate ONLY

PART NUMBER	SIZE
1840-C	3"
1841-C	4"
1842-C	5"
1843-C	6"
1844-C	7"
1845-C	8"

Bolts ONLY

PART NUMBER	SIZE
1629	1/4" x 20 x 2-1/2"
1649	1/4" x 20 x 4"
1659	5/16" x 18 x 4"

## STAINLESS STEEL TUBING CUTTER

Telescoping Tubing Cutter for Stainless Steel

Enclosed feed mechanism  
Removable deburring tool located inside cutter frame  
Cuts up to 1-1/2" stainless steel tubular products



PART NUMBER	DESCRIPTION
37610	Cuts up to 1-1/2"



STAINLESSSTEELPLUMBINGSPECIALTIES  
PAGE 7





*Specification Grade Products for the Plumbing Professional*

## Plumb-Spec™ Questions

---

***What kind of stainless steel is the product made from?***

This product is made from 304 grade stainless steel.

***What gauge is the stainless steel?***

20 gauge.

***Why isn't it made in 17 gauge?***

20 gauge stainless steel will far outlast 17 gauge brass tubular because of the hardness of the metal. Stainless steel is developed to last a lifetime.

***Is the whole trap made from stainless steel?***

Everything is 304 stainless steel except for the slip joint nuts and threads. The slip joint nuts and threads are chrome plated brass.

***Why are the threads and the slip joint nuts not made out of stainless steel?***

Water is not coming into contact with the nuts and threads, therefore, stainless steel is not necessary.

***Is the Plumb-Spec™ product UPC listed?***

The Plumb-Spec™ product is UPC listed and there is a marking on each product.

***What finishes are available?***

Plumb-Spec™ will be available in satin and polished stainless steel. Neither finish has any environmentally damaging chrome plating.

***What gaskets are included?***

Where gaskets are necessary, we include EPDM rubber and beveled plastic gaskets.

***Does the Plumb-Spec™ product meet the plumbing code?***

Check with your local inspector.

***Is the LA trap all stainless steel?***

No, the IPS elbow must be chrome plated cast brass to meet code.

***Do you offer S traps in the Plumb-Spec™ line?***

Not currently. We will be consistently increasing our product offering.





## Plumb-Spec™ Questions Continued

### ***Are the Plumb-Spec™ traps going to be offered with a cleanout?***

Currently, there is no easy process available to connect the brass cleanout to the stainless steel tubular. This may change in the future.

### ***Are you going to have an offset grid strainer in the Plumb-Spec™ line?***

Available as of October 2008.

### ***Will normal tubing cutters work on stainless steel?***

Normal tubing cutters will work on stainless steel but will dull the blade faster. **PASCO** offers a tubing cutter with blades able to cut stainless steel. Replacement blades are also be available.

### ***How hard is it to cut your stainless steel closet bolts?***

A normal brass closet bolt can be cut in approximately 45 seconds. Using the same blade, a stainless steel closet bolt can be cut in approximately 75 seconds.

### ***Are the EZ-ON basket strainers made of stainless steel?***

The body and the strainer are stainless steel. The locking mechanism is not because water is not coming into contact with these parts. The slip joint nut is brass.

### ***Is the grid strainer all stainless?***

No, a portion of the grid strainer is cast brass but the tailpiece is stainless steel. The tailpiece is the part that always fails. Cast brass has a much longer service life than tubular brass.

### ***Why is this product considered to be “green?”***

The chroming process which is used to cover brass tubular is harsh to the environment. The only chrome used on the Plumb-Spec™ products is for the slip joint nuts and threads.

### ***What is the warranty on the Plumb-Spec™ traps and stainless steel tubular?***

There is a lifetime warranty on all Plumb-Spec™ traps and stainless steel tubular. The slip joint nuts will be replaced whenever possible, free of charge.

### ***What are the wall flanges that come with the Plumb-Spec™ product made of?***

In each Plumb-Spec™ trap, you will receive a shallow and box wall flange made of stainless steel.



# Plumb-Spec™

*Specification Grade Products for the Plumbing Professional*

## **EZ ON** Basket Strainer

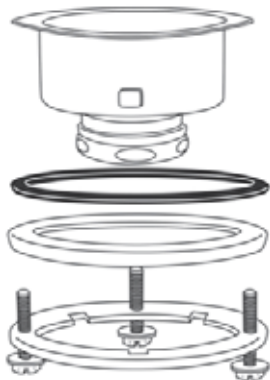

### **#21901**

**Satin Stainless Steel Finish**

**304 stainless steel body**

**Polished drain flange**

**Stainless steel basket**

**Fits sink openings of 3 1/2" to 4"**

### **#21907**

**Bright Polished Stainless Steel Finish**

**304 stainless steel body**

**All surfaces polished**

**Stainless steel basket**

**Fits sink openings of 3 1/2" to 4"**

### **#21905**

**Brushed Nickel Finish**

**All surfaces are PVD finish**

**Finish will not chip or corrode**

**Basket finished to match**

**Fits sink openings of 3 1/2" to 4"**

**Installs in less  
than 30 seconds!**

# Plumb-Spec™

*Specification Grade Products for the Plumbing Professional*

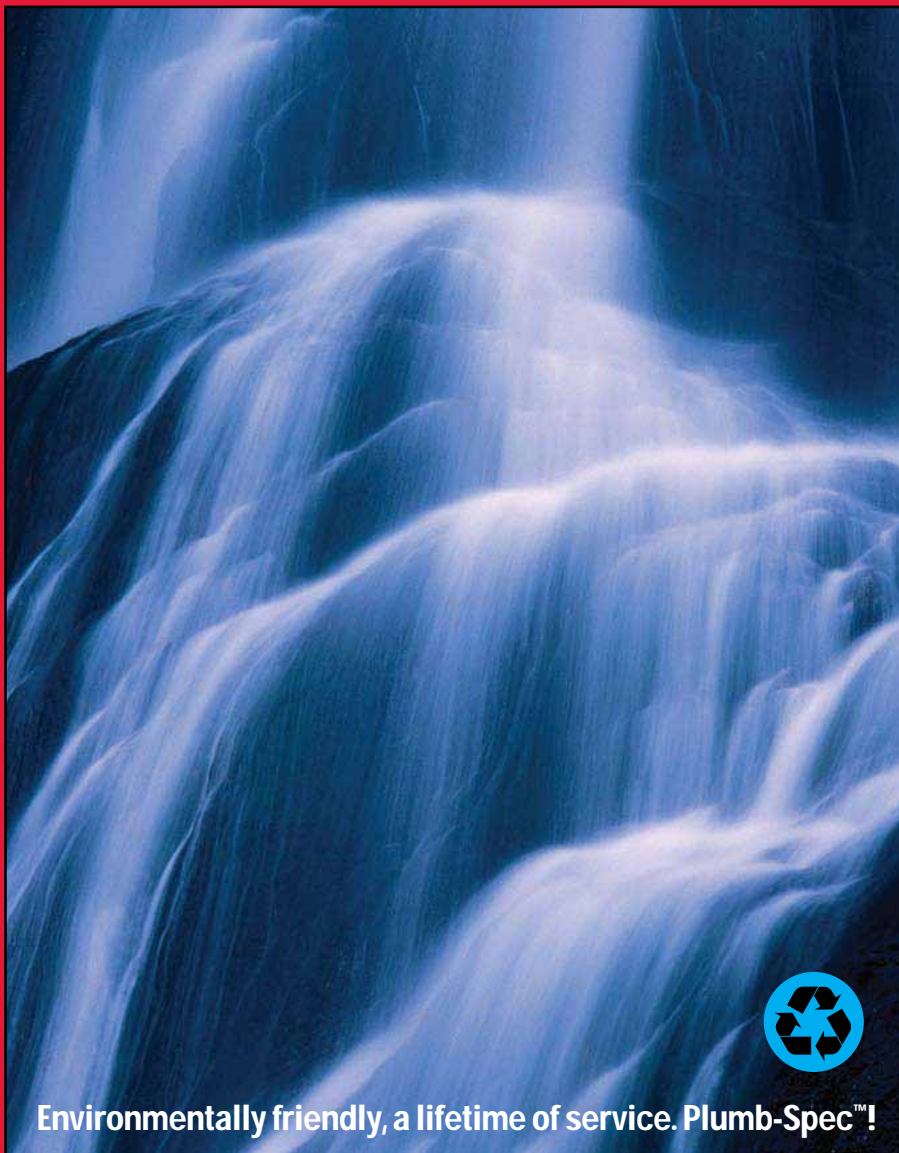

Environmentally friendly, a lifetime of service. Plumb-Spec™!

**Contact *PASCO* today to find out more about Plumb-Spec™:**

P. O. Box 1747  
Lynwood, CA 90262

Phone: (310) 537-7782

Fax: (800) 737-2726

7529 Perryman Court Unit 1  
Curtis Bay, MD 21226

Phone: (410) 360-5010

Fax: (877) 377-6466

**[WWW.PASCOSPECIALTY.COM](http://WWW.PASCOSPECIALTY.COM)**



**STAINLESSSTEELPLUMBINGSPECIALTIES**  
**PAGE 11**

# Plumb-Spec™



*Specification Grade Products for the Plumbing Professional*



## ***Stainless Steel Products***